

ATTENTION:

OBSERVE PRECAUTIONS FOR HANDLING ESD-SENSITIVE DEVICES

Removal/Installation of Major Assemblies - Ion eVo/eVo Walleto/Elite Edge/Megatouch Entertainer

Hard Drive Removal

IMPORTANT NOTE: If you are replacing a PATA hard drive with a SATA hard drive, please see “PATA to SATA Hard Drive Conversion”.

Hard Drive Identification:

To determine whether your hard drive is quick-click or non-quick-click, look for a light gray adapter between the hard drive adapter and the hard drive mounting bracket. See Figure 1. If there is such an adapter, then you have a quick-click hard drive; if not, then your hard drive is non-quick-click. The PATA hard drive with a clamp will simply have a clamp as shown in Figure 1. The SATA hard drive is also shown in Figure 1. The SATA is easily identifiable by the lack of a hard drive ribbon cable and adapter.

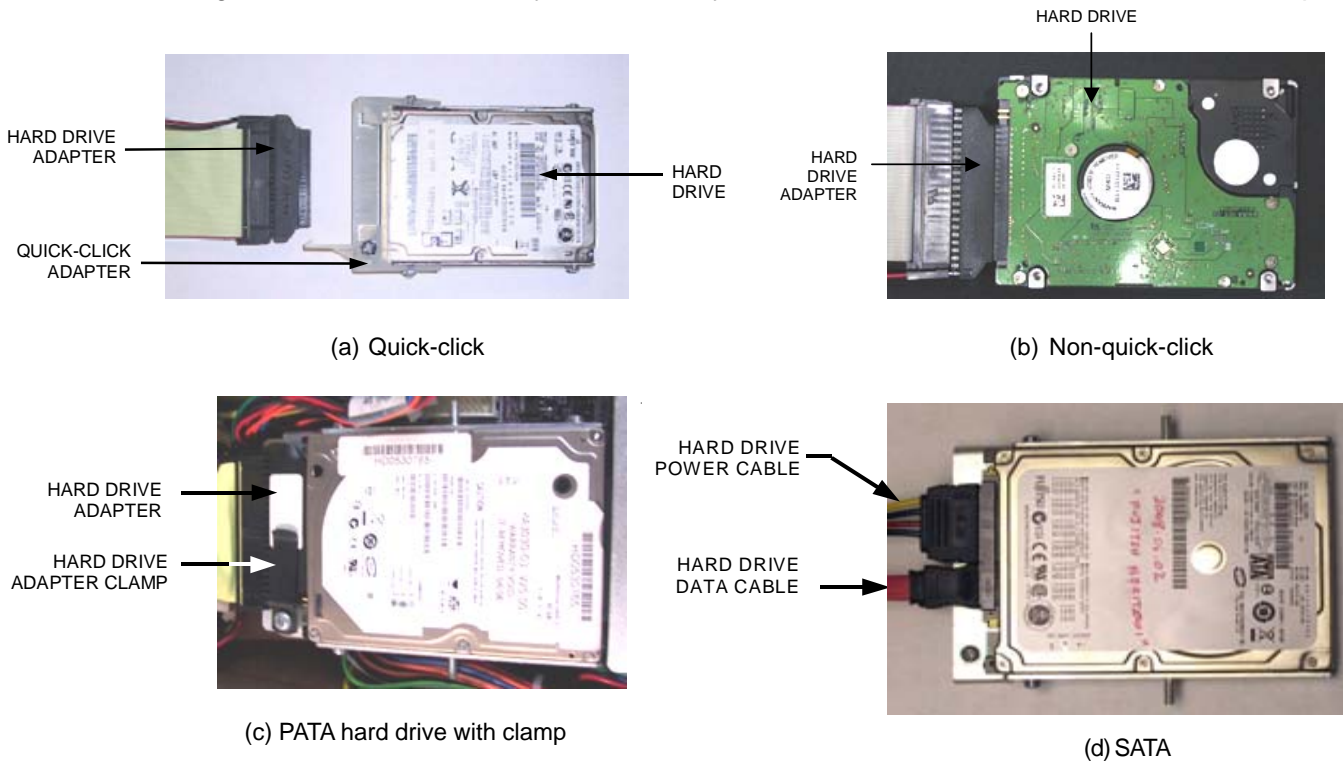

FIGURE 1 - HARD DRIVES

Quick-Click Hard Drive Removal

1. If you are connected to Tournamaxx or Tournachamp you must perform an **Update From Server** before removing the hard drive so that no information is deleted.
2. Turn off and unplug the game.
3. Unlock and open the CPU section.
4. Disconnect the hard drive adapter with the attached ribbon cable from the hard drive (Figure 2).

ATTENTION:

OBSERVE PRECAUTIONS FOR HANDLING ESD-SENSITIVE DEVICES

Removal/Installation of Major Assemblies - Ion eVo/eVo Walleto/Elite Edge/Megatouch Entertainer (cont'd)

5. Remove the single screw securing the hard drive mounting bracket to the underlying mounting plate (see Figure 2). This screw will not be reused.
6. Remove the hard drive and the attached bracket from the mounting plate by sliding the assembly down and off its mounting plate.

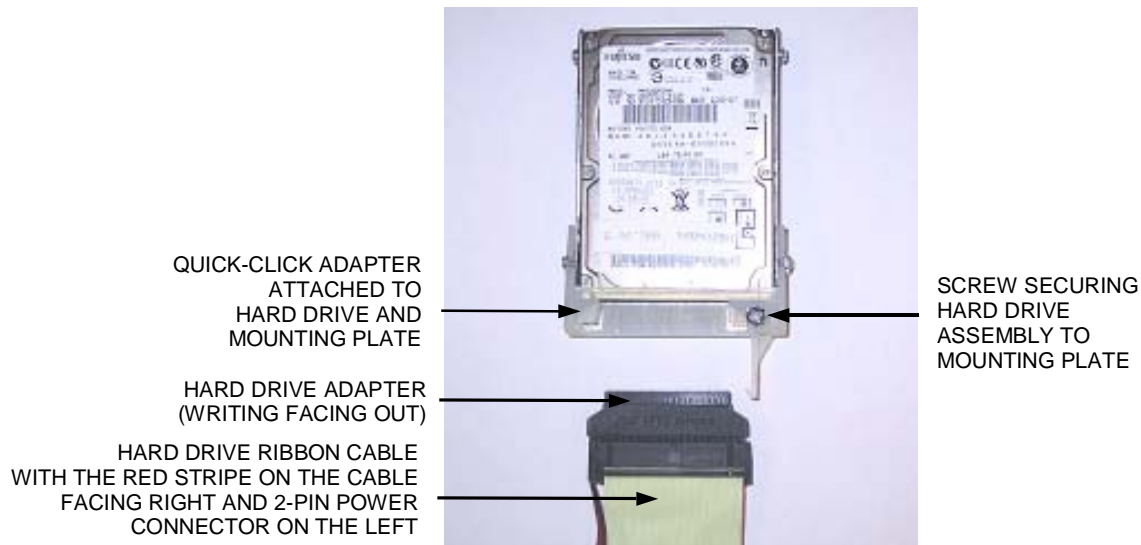

FIGURE 2 - QUICK-CLICK HARD DRIVE ASSEMBLY CONNECTION

Quick-Click Hard Drive Installation

1. Attach the hard drive ribbon cable in the game to the new hard drive by lining up the left side of the hard drive adapter with the pins on the hard drive, and then carefully inserting it all the way into the quick-click adapter (see Figure 2 for proper orientation).
2. Slide the new hard drive assembly onto the game's mounting plate. Align the mounting bracket with the screw hole on the mounting plate, then secure the supplied screw in place (see Figure 2).
3. Close and lock the CPU section.
4. Plug in and turn on the game. The game will reboot twice to configure the hardware. When prompted, perform a touchscreen calibration.
5. If you are connected to TournaMAXX or TournaCHAMP you must re-enter the dial-in settings after completing the software upgrade. After entering the settings, make the initial call into the server and then perform two **Updates From Server**. Refer to the MegaNet manual for information on how to perform these functions.

ATTENTION:

OBSERVE PRECAUTIONS FOR HANDLING ESD-SENSITIVE DEVICES

Removal/Installation of Major Assemblies - Ion eVo/eVo Walleto/Elite Edge/Megatouch Entertainer (cont'd)

Non-Quick-Click Hard Drive Removal

1. If you are connected to Tournamaxx or Tournachamp you must perform an **Update From Server** before removing the hard drive so that no information is deleted.
2. Turn off and unplug the game.
3. Unlock and open the CPU section.
4. Remove the single screw securing the hard drive mounting bracket to the underlying mounting plate. See Figure 3.
5. Remove the hard drive assembly by sliding it down and off its mounting plate. Disconnect the hard drive adapter, along with the hard drive ribbon cable, from the hard drive.

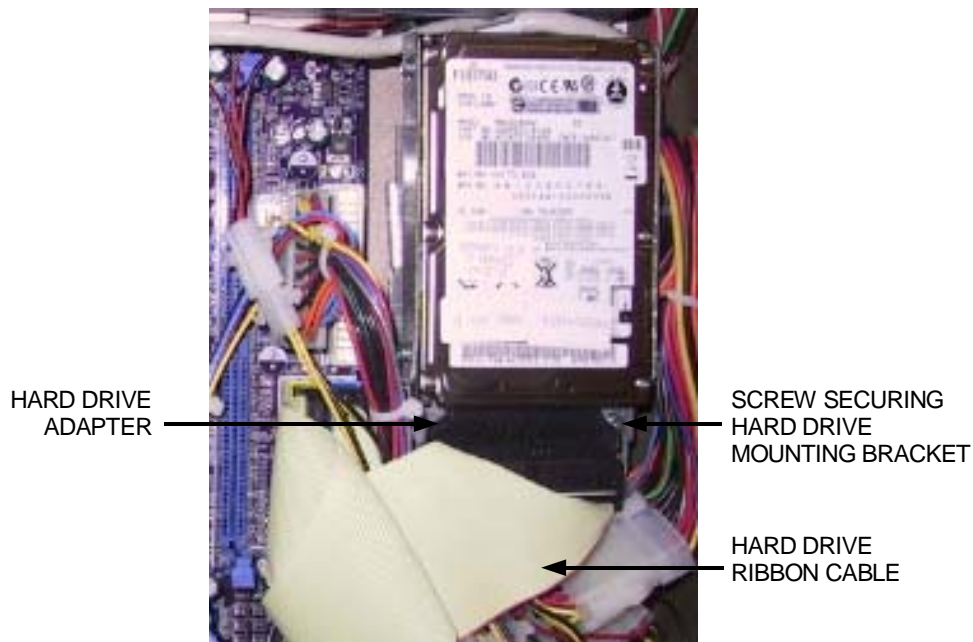

FIGURE 3 - NON-QUICK-CLICK HARD DRIVE REMOVAL

ATTENTION:

OBSERVE PRECAUTIONS FOR HANDLING ESD-SENSITIVE DEVICES

Removal/Installation of Major Assemblies - Ion eVo/eVo Wallette/Elite Edge/Megatouch Entertainer (cont'd)

Non-Quick-Click Hard Drive Installation

1. Connect the hard drive adapter and attached ribbon cable to the supplied hard drive according to Figure 4. Note that 4 pins on the hard drive are set off and will remain unconnected. Make certain that the red stripe on the ribbon cable (indicating pin-1 position) is inserted facing the unconnected pins. The writing on the plastic of the hard drive adapter and the black wire on the 2-pin power cable should be facing out when installed into the game.
2. Slide the new hard drive assembly onto the hard drive mounting plate and secure it in place with a single screw (Figure 3).

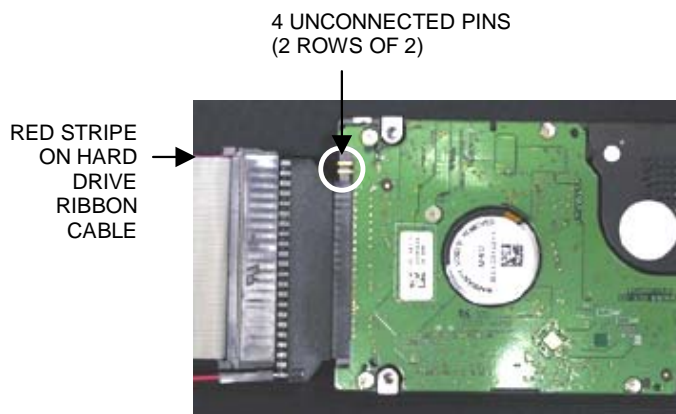

FIGURE 4 - CIRCUIT-BOARD SIDE OF HARD DRIVE

3. Close and lock the CPU section.
4. Plug in and turn on the game. The game will reboot twice to configure the hardware. When prompted, perform a touchscreen calibration.
5. If you are connected to TournaMAXX or TournaCHAMP you must re-enter the dial-in settings after completing the software upgrade. After entering the settings, make the initial call into the server and then perform two Updates From Server. Refer to the MegaNet manual for information on how to perform these functions.

ATTENTION:

OBSERVE PRECAUTIONS FOR HANDLING ESD-SENSITIVE DEVICES

Removal/Installation of Major Assemblies - Ion eVo/eVo Walleto/Elite Edge/Megatouch Entertainer (cont'd)

PATA Hard Drive (with clamp) Removal

1. If you are connected to TournaMAXX or TournaCHAMP you must perform an **Update From Server** before removing the hard drive so that no information is deleted.
2. Turn off and unplug the game.
3. Unlock and open the CPU section.
3. Remove the screw securing the hard drive mounting bracket to its mounting plate (see Figure 5). This screw will not be reused.
4. Remove the hard drive from its mounting plate by sliding the assembly down and off the mounting plate. Disconnect the hard drive adapter and attached ribbon cable from the hard drive (see Figure 5). Then, separate the hard drive adapter from the ribbon cable and 2-pin power cable. This hard drive adapter will not be reused.

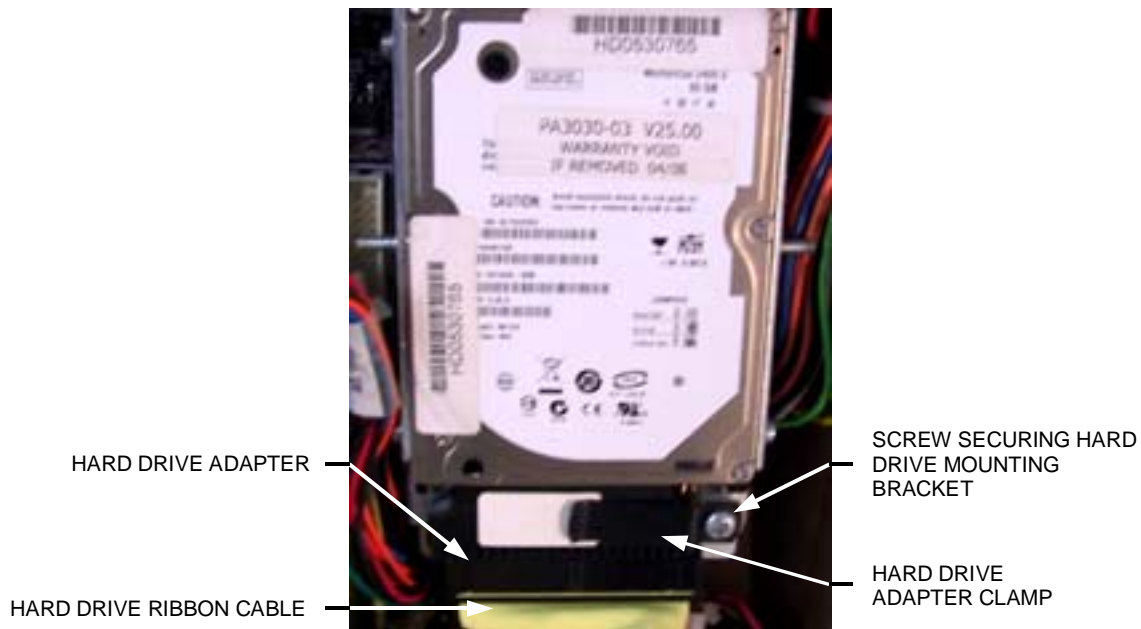

FIGURE 5 - CLOSEUP OF PATA HARD DRIVE WITH CLAMP

ATTENTION:

OBSERVE PRECAUTIONS FOR HANDLING ESD-SENSITIVE DEVICES

Removal/Installation of Major Assemblies - Ion eVo/eVo Wallette/Elite Edge/Megatouch Entertainer (cont'd)

PATA Hard Drive (with clamp) Installation

1. Attach the 2-pin power cable in the game to the new hard drive adapter, which comes attached to the new hard drive. Do so by locating the two stand-alone pins on the hard drive adapter, and then sliding the 2-pin adapter onto these pins (for help, see the label on the hard drive adapter - see Figure 5). Note: The black wire on the power cord **MUST** be facing toward the label side of the hard drive adapter. Failure to do so could result in a damaged hard drive.
2. Attach the hard drive ribbon cable in the game to the new hard drive. Do so by lining up the pins on the hard drive adapter with the mating holes on the ribbon cable (the red stripe on the ribbon cable should be on the side opposite the power cable). Carefully insert the ribbon cable all the way into the adapter so that it is fully seated.
3. Slide the new hard drive assembly onto the game's mounting plate. Be sure that the hard drive is flush to the mounting plate when doing so. Both the label on the plastic of the hard drive adapter and the label on the hard drive itself should be facing out. Align the hole in the mounting bracket with the hole on the mounting plate, then secure the supplied screw, washer, and clamp to the mounting plate (see Figure 5). The clamp should rest on the hard drive adapter, holding it in place when screwed in tightly.
4. Close and lock the CPU section.
5. Plug in and turn on the game. The game will reboot twice to configure the hardware. When prompted, perform a touchscreen calibration.
6. If you are connected to Tournamaxx or Tournachamp you must re-enter the dial-in settings after completing the software upgrade. After entering the settings, make the initial call into the server and then perform two Updates From Server. Refer to the MegaNet manual for information on how to perform these functions.

ATTENTION:

OBSERVE PRECAUTIONS FOR HANDLING ESD-SENSITIVE DEVICES

Removal/Installation of Major Assemblies - Ion eVo/eVo Walleto/Elite Edge/Megatouch Entertainer (cont'd)

SATA Hard Drive Removal

1. If you are connected to TournaMAXX or TournaCHAMP you must perform an **Update From Server** before removing the hard drive so that no information is deleted.
2. Turn off and unplug the game.
3. Unlock and open the CPU section.
4. Disconnect the hard drive data and power cables from the hard drive (see Figure 6).
5. Remove the screw securing the hard drive mounting bracket to its mounting plate (see Figure 6). Remove the hard drive from its mounting plate by sliding the assembly down and off the mounting plate.

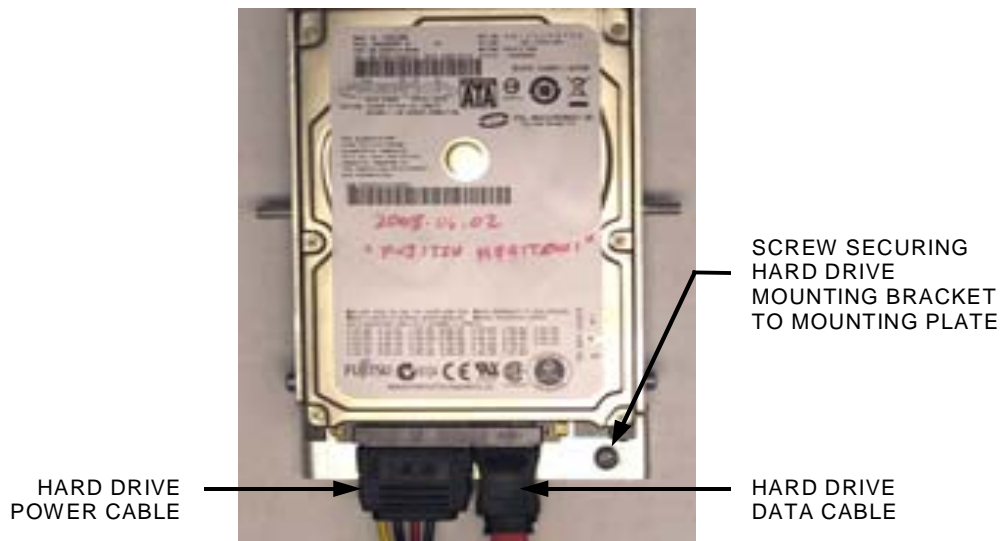

FIGURE 6 - CLOSEUP OF SATA HARD DRIVE

SATA Hard Drive Installation

1. Slide the hard drive assembly onto the game's mounting plate and screw it into place to secure it (see Figure 6).
2. Attach the hard drive data and power cables (see Figure 6).
3. Close and lock the CPU section.
4. Plug in and turn on the game. The game will reboot twice to configure the hardware. When prompted, perform a touchscreen calibration.
5. If you are connected to TournaMAXX or TournaCHAMP you must re-enter the dial-in settings after completing the software upgrade. After entering the settings, make the initial call into the server and then perform two Updates From Server. Refer to the MegaNet manual for information on how to perform these functions.